

### 3.2b FIRE BARRIER CABLE GLAND - DNCR series

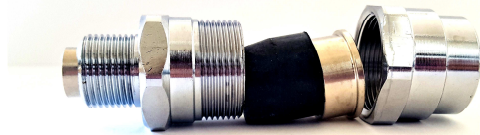

**CHARACTERISTICS:** For unarmoured cable, outer seal.  
 Suitable for flexible conduit coupling.  
 Suitable for enclosures over 2 litres whit sparking equipments

**APPLICATION:** For general use, indoors and outdoors

**PROTECTION DEGREE:** IP66.

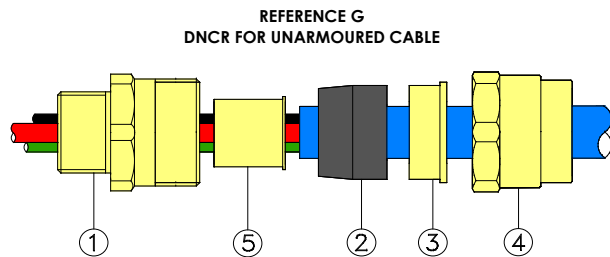

- REFERENCE G  
 DNCR FOR UNARMoured CABLE
- 1 - Body
  - 2 - Seal
  - 3 - Press-ring
  - 4 - Gland nut
  - 5 - Sealing chamber

**NOTE:** thread **G**=ISO 7/1 RP-BSPP. Other threads on request.

→Sample of designation: **DNCR1.10 M20x1,5**

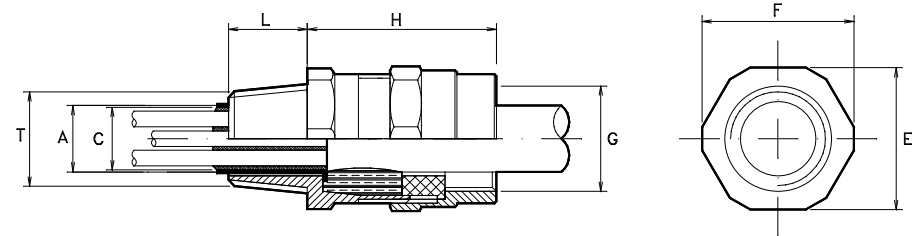

L=Thread length: see comparison table

| SIZE | Thread<br>T  | Cable dimensions<br>TYPE | A    |      | C<br>mm | H<br>mm | E<br>mm | F<br>mm | G<br>mm |
|------|--|--------------------------|------|------|---------|---------|---------|---------|---------|
|      |  |                          | min  | max  |         |         |         |         |         |
| 1    | 1/2"NPT - M20x1,5 - Pg13,5<br>3/4"NPT - M25x1,5 - Pg16 | DNCR1.8                  | 5,5  | 8    | 12      | 42      | 32      | 35      | 1/2"    |
|      |  | DNCR1.10                 | 8    | 10,5 |         |         |         |         |         |
|      |  | DNCR1.13                 | 10,5 | 13   |         |         |         |         |         |
| 2    | 3/4"NPT - M25x1,5 - Pg16                               | DNCR2.13                 | 10,5 | 13   | 17      | 45      | 36      | 39      | 3/4"    |
|      |  | DNCR2.15                 | 13   | 15,5 |         |         |         |         |         |
|      |  | DNCR2.18                 | 15,5 | 18   |         |         |         |         |         |
| 3    | 1"NPT - M32x1,5 - Pg21                                 | DNCR3.18                 | 15   | 18   | 23      | 54      | 45      | 49      | 1"      |
|      |  | DNCR3.21                 | 18   | 21   |         |         |         |         |         |
|      |  | DNCR3.24                 | 21   | 24   |         |         |         |         |         |
| 4    | 1"1/4NPT - M40x1,5 - Pg29                              | DNCR4.24                 | 21   | 24   | 29      | 55      | 50      | 55      | 1"1/4   |
|      |  | DNCR4.27                 | 24   | 27   |         |         |         |         |         |
|      |  | DNCR4.30                 | 27   | 30   |         |         |         |         |         |
| 5    | 1"1/2NPT - M50x1,5 - Pg36                              | DNCR5.27                 | 24   | 27   | 35      | 55      | 57      | 62      | 1"1/2   |
|      |  | DNCR5.30                 | 27   | 30   |         |         |         |         |         |
|      |  | DNCR5.33                 | 30   | 33   |         |         |         |         |         |
|      |  | DNCR5.36                 | 33   | 36   |         |         |         |         |         |
| 6    | 2"NPT - M63x1,5 - Pg42                                 | DNCR6.39                 | 36   | 39   | 45      | 55      | 67      | 73      | 2"      |
|      |  | DNCR6.42                 | 39   | 42   |         |         |         |         |         |
|      |  | DNCR6.45                 | 42   | 45   |         |         |         |         |         |